

'live-with': ...dwelling and workplace functions contained within a single com

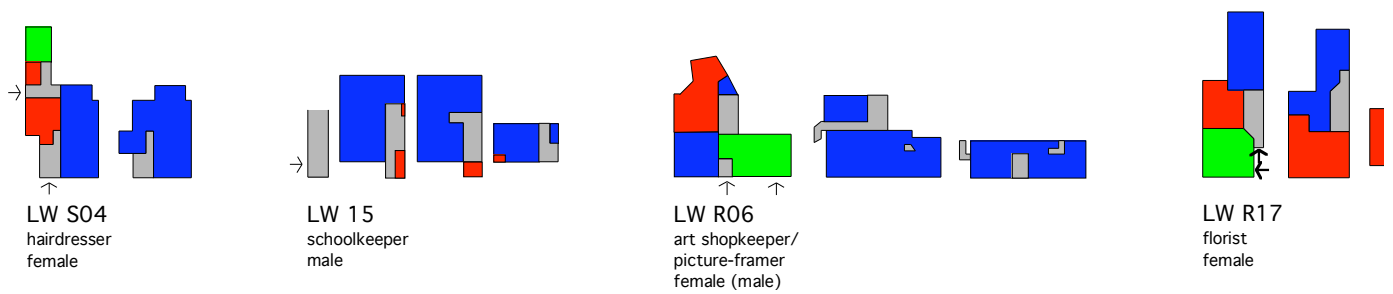

'live-adjacent': ...workplace in a separate compartment from, but attac

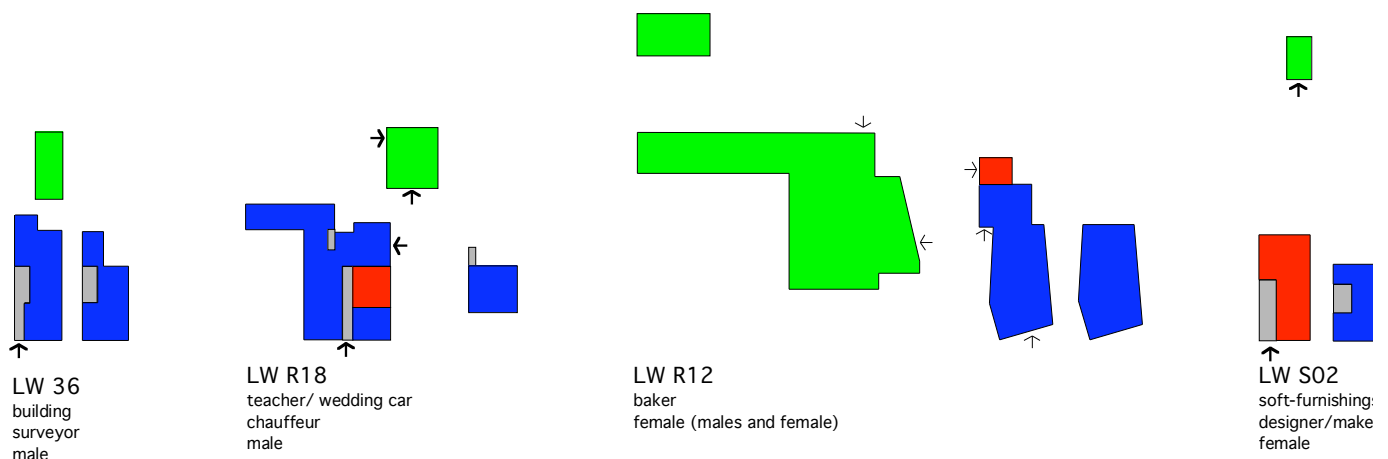

'live-nearby': ...workplace detached and at a small distance from dwelling

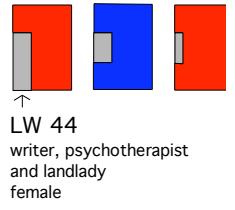
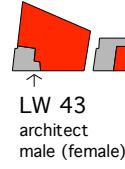
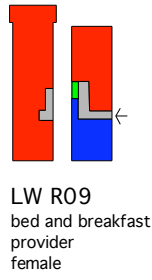
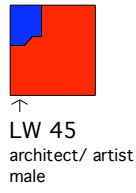

partment with with a single entrance

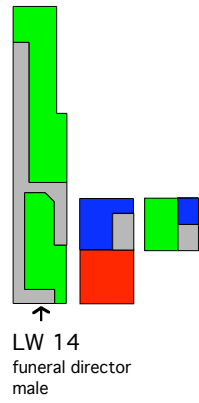
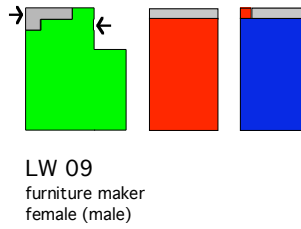
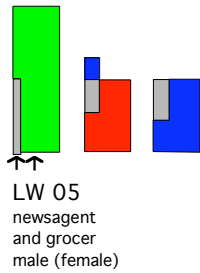
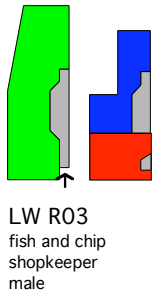

hed (either above, below, or next-door) to, dwelling, with a separate entrance

s
r

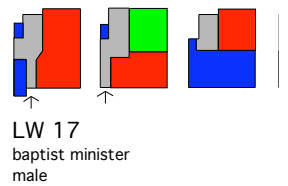
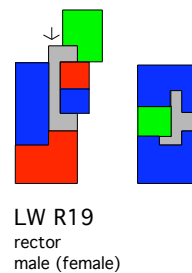
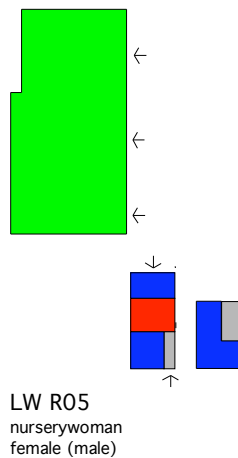
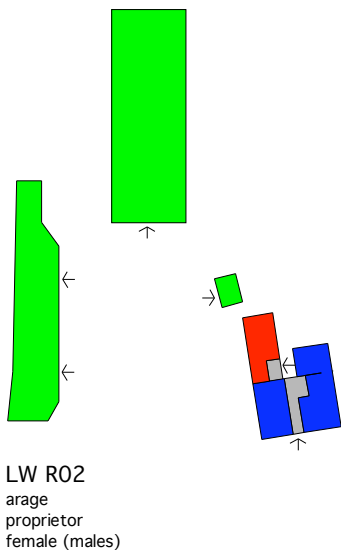

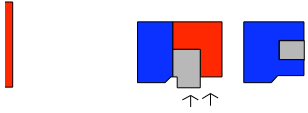

LW S01
newspaper
distribution
agent
female

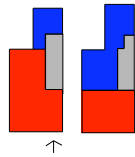

LW 32
journalist
female (male)

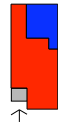

LW 48
childminder
female

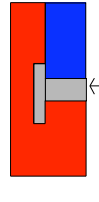

LW 49
re-birthing
breath-work
practitioner
female

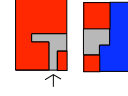

LW 47
childminder
female

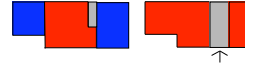

LW 21
curator
female (male)

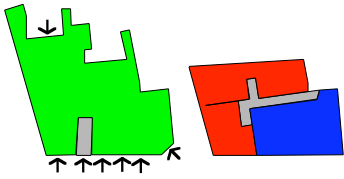

male)

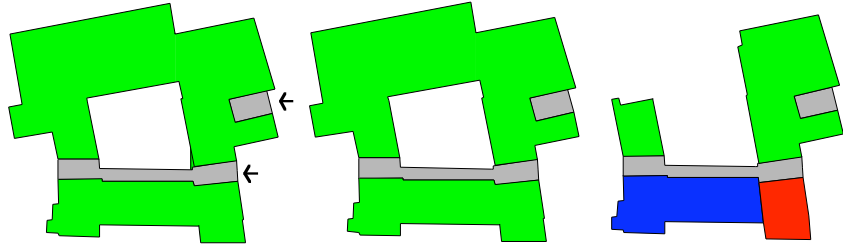

LW 30
manager of
historic house
female



LW R11
publican
female (r

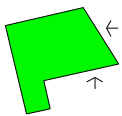

LW R22
mechanic/
picture framer
male (female)

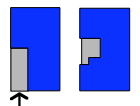
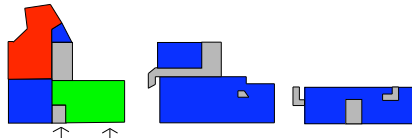

LW S03
graphic
designer
female

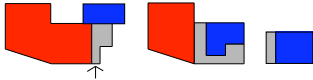

LW R04
classical
musician
female

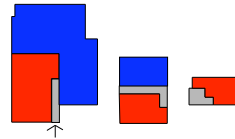

LW R10
IT worker
male (female)

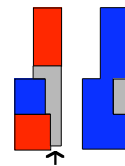

LW 16
architect
male

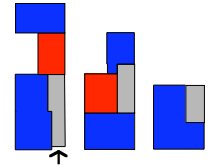

LW 01
social policy
researcher
female

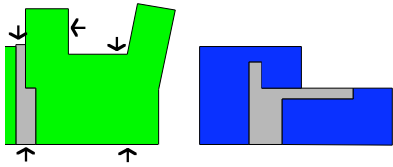

male)

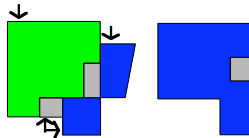

LW R01
newsagent
and grocer
male (female)

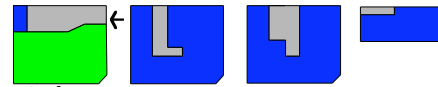

LW 12
mechanic
male

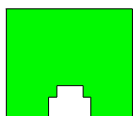
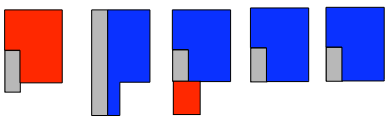

LW 08
architect
female (male)

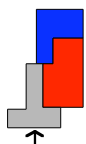

LW 25
website
designer
male

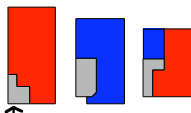

LW 10
costume
designer/maker
female (female)

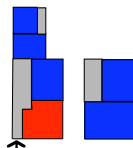

LW 02
music teacher
female

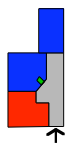

LW 13
illustrator
male

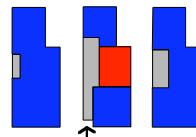

LW 20
writer/editor
female

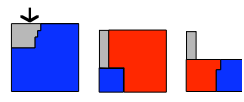

LW 40
architect
male

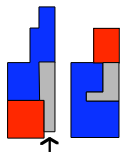

LW 22
clothing
salesperson

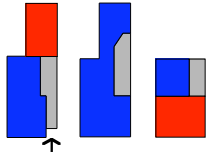

LW 28
academic
male

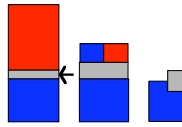

LW R13
nutritionalist
female

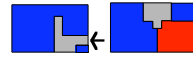

LW 46
PhD student
male

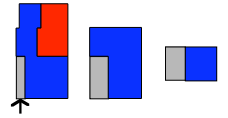

LW R08
plumber
male (female)

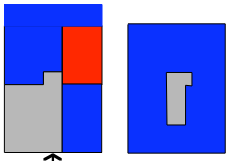

LW 18
BT manager
male

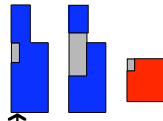

LW R16
needlewoman
female (male)

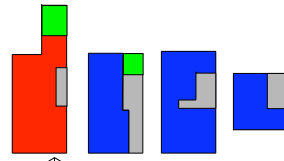

LW 06
academic
female

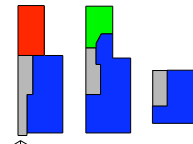

LW 27
musician/ events
organiser
male

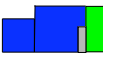

LW 29
photographer
male (female)

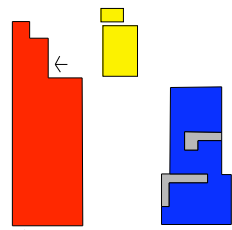
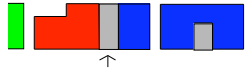

LW R07
caterer/
preserve maker
female



LW 39
translator
male (female)

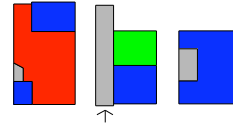

LW 11
baptist minister
female

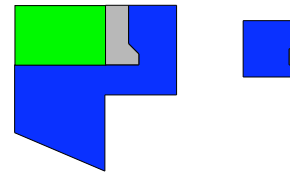

LW R15
managing director of
manufacturing company
male

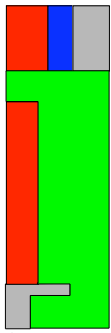

LW 42
artist
male (males and females)

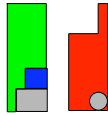

LW 41
artist
male



LW 23
architect
male

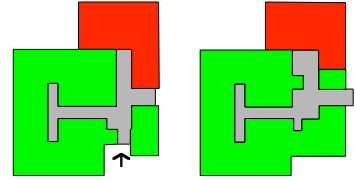

LW R20
care-worker
female



LW
carp
male

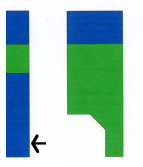

34
enter

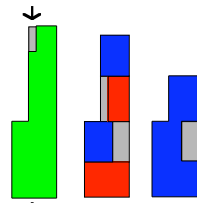

LW 19
newsagent
and grocer
male (female and male)

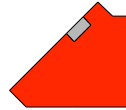

LW 03
photographer
female

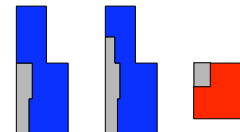
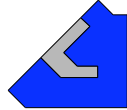

LW 04
graphic designer
male (female)

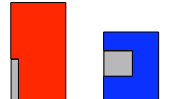

LW R21
piece-working
manufacturer
female

- home
- work
- home and work
- circulation
- separate 'work' storage

Fold-out drawing no. 4:
Building typology no. 2: Spa
 (male/female in brackets in
 home-based worker in the h

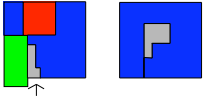

LW S05
curtain-
maker
female

patial design strategy
indicates the presence of another
household)
